

# STANDARD DIN *20 series*

## Single channel switches with pre-set or free programming options

- ▶ 24hr or 7 day versions available
- ▶ Designed for applications where space economy is a factor



20821

20722

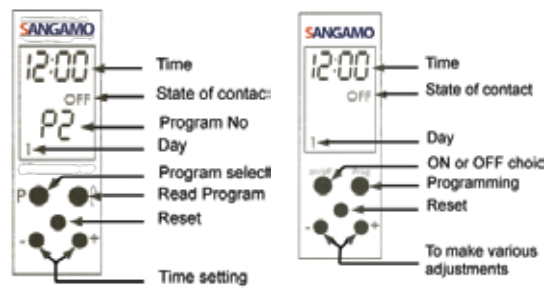

### Dimensions

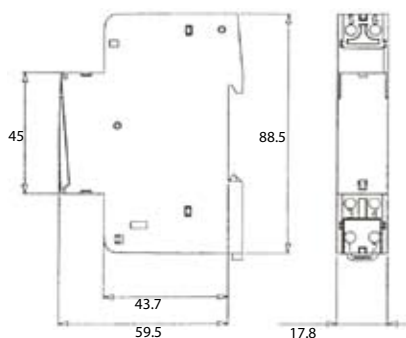

### Electrical Connections

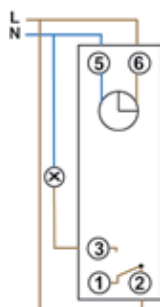

### Mounting



Product Range	
<b>20110</b>	24h, choice between 5 pre-registered & adjustable programs. Max 6 switchings per day
<b>20821</b>	7 day, choice between 10 pre-registered & adjustable programs. Max 6 switchings per day
<b>20722</b>	7 day, 10 free programs. Max 6 switchings per day
<b>143602</b>	Compatible IP40 enclosure

		Technical characteristics
Supply voltage		230 V +/- 10%
Frequency		50 Hz
Power reserve		Lithium battery with 5 years reserve
Power consumption		approx. 1 VA
Changeover contacts	resistive load	16 A 250 V
	inductive load (cos φ = 0.6)	3 A 250 V
Accuracy of operation		1 sec / 24 h.
Operating temperature		-10 °C to +50 °C
Storage temperature		-10 °C to +60 °C
Connection by cage terminals, section of conductors		0.5 to 4 mm <sup>2</sup>
Conformity to standard BS EN 60730		yes
Performance indicated for an ambient temperature of 20 °C		